

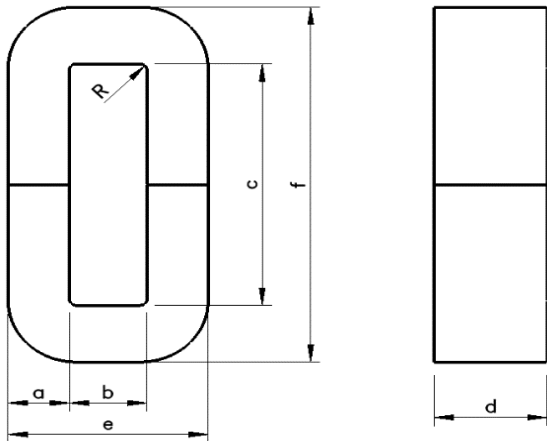

MACC1000

110 Delta Drive
 Pittsburgh, PA 15238
 NAFTA Sales: (1) 800-245-3984
 HK Sales: (852) 3102-9337
 magnetics@spang.com
 www.mag-inc.com



	Dim (mm)	tol +/-
a	33.0	1.0
b	40.0	min
c	105.0	min
d	85.0	1.5
e	106.0	+1.0/-0.5
f	171.0	+5.0/-0.0
R	2.0	Ref

A _e (cm ²)	L _e (cm)	Weight (g)	Wa(cm ²)
23.0	42.2	7100 ref	42.0 ref

Material	Amorphous
Core Loss (@16kHz/37mT, 25° C +/- 3° C, Humidity 65% +/- 5%)	≤1.38 W/kg
Working Temperature	-40°C + 130°C
Storage Temperature	-40°C + 80°C