

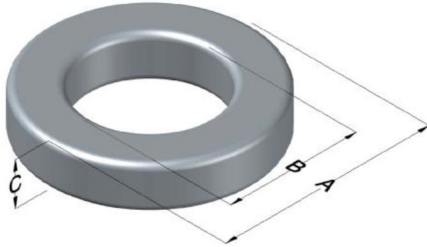

C058548A2HT22

110 Delta Drive
 Pittsburgh, PA 15238
 NAFTA Sales: (1)800-245-3984
 HK Sales : (852)3102-9337
 magnetics@spang.com
 www.mag-inc.com



High Flux Permeability (μ)	A_L (nH/T ²)	Core Marking			Coating Color
		Lot Number	Part Number	Inductance Grade	
125	254 ± 8%	XXXXXX	58548A2HT22	X	Khaki

Dimensions	Uncoated		Coated Limits			Packaging
	(mm)	(in)	(mm)	(in)		
OD (A)	32.79	1.291	33.66	1.325	max	Cardboard cut-outs Box Qty= TBD
ID (B)	20.09	0.791	19.46	0.766	min	
HT (C)	21.3	0.840	22	0.866	max	

Electrical Characteristics			Physical Characteristics						
Watt Loss @ 100 kHz, 100mT max (mW/cm ³)	DC Bias min (oersteds)		Voltage Breakdown wire to wire min (V _{AC})	Break Strength min (kg)	Window Area W _A (mm ²)	Cross Section A _e (mm ²)	Path Length L _e (mm)	Volume V _e (mm ³)	Weight (g)
	80%	50%							
1000	46	81	3000	79.0	297	131.2	81.4	10,700	88

Winding Information					Temperature Rating	
Winding Length Per Turn				Wound Coil Dimensions (mm)		Curie Temp: 500°C
Winding Factor	(mm)	Winding Factor	(mm)	40% Winding Factor		Coating Temp (Continuous up to): 200°C
				OD	36.8	
				HT	28.3	Notes:
				Max OD	46.7	
				Max HT	38.5	
0%	58.3	40%	68.2	Completely Full Window		
20%	63.2	45%	69.5	Surface Area (mm ²)		
25%	64.3	50%	70.9			
30%	65.6	60%	74.0	Unwound Core	4,900	
35%	66.8	70%	77.4	40% Winding Factor	6,900	

