

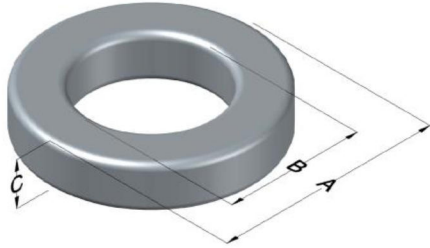

C058439A2HT25

110 Delta Drive
 Pittsburgh, PA 15238
 NAFTA Sales: (1)800-245-3984
 HK Sales : (852)3102-9337
 magnetics@spang.com
 www.mag-inc.com



High Flux Permeability (μ)	A_L (nH/T ²)	Core Marking			Coating Color
		Lot Number	Part Number	Inductance Grade	
60	180 ± 8%	XXXXXX	58439A2HT25	X	Khaki

Dimensions	Uncoated		Coated Limits			Packaging
	(mm)	(in)	(mm)	(in)		
OD (A)	46.73	1.840	47.63	1.875	max	Cardboard cut-outs Box Qty= 75 pcs
ID (B)	24.13	0.950	23.32	0.918	min	
HT (C)	24.1	0.949	25.0	0.984	max	

Electrical Characteristics			Physical Characteristics						
Watt Loss @ 100 kHz, 100mT max (mW/cm ³)	DC Bias min (oersteds)		Voltage Breakdown wire to wire min (V _{AC})	Break Strength min (kg)	Window Area W _A (mm ²)	Cross Section A _e (mm ²)	Path Length L _e (mm)	Volume V _e (mm ³)	Weight (g)
	80%	50%							
900	90	170	3000	233	427	266	107	28,460	240

Winding Information					Temperature Rating	
Winding Length Per Turn				Wound Coil Dimensions (mm)		Curie Temp: 500°C
Winding Factor	(mm)	Winding Factor	(mm)	40% Winding Factor		Coating Temp (Continuous up to): 200°C
				OD	51.2	Notes:
				HT	32.0	
				Completely Full Window		
				Max OD	63.8	
				Max HT	44.7	
				Surface Area (mm ²)		
				Unwound Core		8,300
				40% Winding Factor		12,000
0%	74.3	40%	86.1			
20%	80.1	45%	87.8			
25%	81.6	50%	89.4			
30%	83.0	60%	93.0			
35%	84.6	70%	97.0			

