

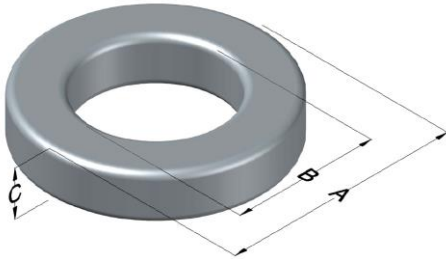

C058351A2HT17

110 Delta Drive
 Pittsburgh, PA 15238
 NAFTA Sales: (1)800-245-3984
 HK Sales : (852)3102-9337
 magnetics@spang.com
 www.mag-inc.com



High Flux Permeability (μ)	A_L (nH/T ²)	Core Marking			Coating Color
		Lot Number	Part Number	Inductance Grade	
60	93 ± 8%	XXXXXX	58351A2HT17	X	Khaki

Dimensions	Uncoated		Coated Limits			Packaging
	(mm)	(in)	(mm)	(in)		
OD (A)	23.57	0.928	24.33	0.958	max	Cardboard cut-outs Box Qty= TBD
ID (B)	14.40	0.567	13.77	0.542	min	
HT (C)	16.2	0.639	17.0	0.669	max	

Electrical Characteristics			Physical Characteristics						
Watt Loss @ 100 kHz, 100mT max (mW/cm ³)	DC Bias min (oersteds)		Voltage Breakdown wire to wire min (V _{AC})	Break Strength min (kg)	Window Area W _A (mm ²)	Cross Section A _e (mm ²)	Path Length L _e (mm)	Volume V _e (mm ³)	Weight (g)
	80%	50%							
900	90.0	170	2000	47.0	149	70.8	58.8	4160	32

Winding Information					Temperature Rating	
Winding Length Per Turn				Wound Coil Dimensions (mm)		Curie Temp: 500°C
Winding Factor	(mm)	Winding Factor	(mm)	40% Winding Factor		Coating Temp (Continuous up to): 200°C
				OD	26.7	Notes:
0%	44.7	40%	51.8	HT	21.5	
				Max OD	33.5	
20%	48.2	45%	52.7	Max HT	28.7	
25%	49.0	50%	53.7	Surface Area (mm ²)		
30%	49.9	60%	55.9	Unwound Core	2,700	
35%	50.8	70%	58.3	40% Winding Factor	3,700	

