

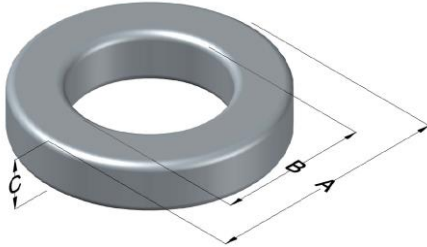

C055930A9

110 Delta Drive
 Pittsburgh, PA 15238
 NAFTA Sales: (1)800-245-3984
 HK Sales : (852)3102-9337
 magnetics@spang.com
 www.mag-inc.com



MPP Permeability (μ)	A_L (nH/T ²)	Core Marking			Coating Color
		Lot Number	Part Number	Inductance Grade	
125	157 ± 8%	XXXXXX	55930A9	X	Gray

Dimensions	Uncoated		Coated Limits			Packaging
	(mm)	(in)	(mm)	(in)		
OD (A)	27.10	1.067	28.07	1.105	max	Cardboard cut-outs Box Qty= 400 pcs
ID (B)	14.40	0.567	13.72	0.540	min	
HT (C)	11.80	0.465	12.32	0.485	max	

Electrical Characteristics			Physical Characteristics						
Watt Loss @ 100 kHz, 100mT max (mW/cm ³)	DC Bias min (oersteds)		Voltage Breakdown wire to wire min (V _{AC})	Break Strength min (kg)	Window Area W _A (mm ²)	Cross Section A _e (mm ²)	Path Length L _e (mm)	Volume V _e (mm ³)	Weight (g)
	850	80%							
	25.0	48.5							

Winding Information					Temperature Rating			
Winding Length Per Turn				Wound Coil Dimensions (mm)			Curie Temp: 460 °C	
Winding Factor	(mm)	Winding Factor	(mm)	40% Winding Factor		OD	30.0	
				HT	16.5	Coating Temp (Continuous up to): 200 °C		
				Completely Full Window		Max OD	37.3	
						Max HT	24.0	
				Surface Area (mm ²)			Notes:	
				Unwound Core		2,400		
				40% Winding Factor		3,500		
0%	37.5	40%	44.6					
20%	41.1	45%	45.7					
25%	41.9	50%	46.6					
30%	42.8	60%	48.8					
35%	43.8	70%	51.3					

Typical DC Bias Performance

