

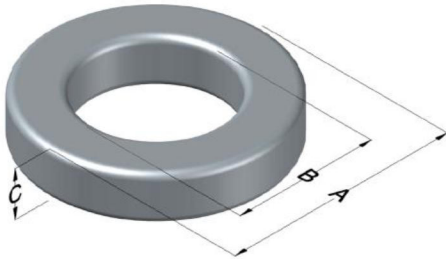

# C055128A2

110 Delta Drive  
 Pittsburgh, PA 15238  
 NAFTA Sales: (1)800-245-3984  
 HK Sales : (852)3102-9337  
 magnetics@spang.com  
 www.mag-inc.com



MPP Permeability ( $\mu$ )	$A_L$ (nH/T <sup>2</sup> )	Core Marking			Coating Color
		Lot Number	Part Number	Inductance Grade	
160	68 ± 8%	XXXXXX	128A2	X	Gray

Dimensions	Uncoated		Coated Limits			Packaging
	(mm)	(in)	(mm)	(in)		
OD (A)	11.18	0.440	11.81	0.465	max	Bulk Pack 4 bags/box Box Qty= 6000 pcs
ID (B)	6.35	0.250	5.84	0.230	min	
HT (C)	3.96	0.156	4.60	0.181	max	

Electrical Characteristics			Physical Characteristics						
Watt Loss @ 100 kHz, 100mT max(mW/cm <sup>3</sup> )	DC Bias min (oersteds)		Voltage Breakdown wire to wire min (V <sub>AC</sub> )	Break Strength min (kg)	Window Area W <sub>A</sub> (mm <sup>2</sup> )	Cross Section A <sub>e</sub> (mm <sup>2</sup> )	Path Length L <sub>e</sub> (mm)	Volume V <sub>e</sub> (mm <sup>3</sup> )	Weight (g)
	80%	50%							
900	21.0	39.0	1250	11.8	26.8	9.06	26.9	244	2.1420

Winding Information					Temperature Rating	
Winding Length Per Turn				Wound Coil Dimensions (mm)		Curie Temp: 460°C
Winding Factor	(mm)	Winding Factor	(mm)	40% Winding Factor		Coating Temp (Continuous up to): 200°C
				OD	12.9	Notes:
0%	15.2	40%	18.1	HT	6.53	
				Completely Full Window		
20%	16.7	45%	18.6	Max HT	8.97	
25%	17.0	50%	19.0	Surface Area (mm <sup>2</sup> )		
30%	17.4	60%	19.9	Unwound Core	420	
35%	17.8	70%	20.9	40% Winding Factor	600	

## Typical DC Bias Performance

