

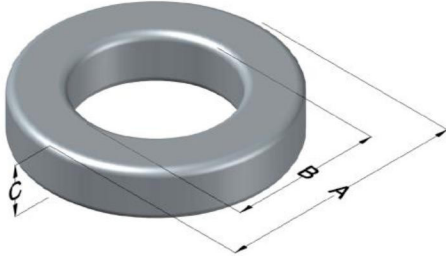

# C055117M4

110 Delta Drive  
 Pittsburgh, PA 15238  
 NAFTA Sales: (1)800-245-3984  
 HK Sales : (852)3102-9337  
 magnetics@spang.com  
 www.mag-inc.com



MPP Permeability ( $\mu$ )	$A_L$ (nH/T <sup>2</sup> )	Core Marking			Coating Color
		Lot Number	Part Number	Inductance Grade	
200	115 ± 8%	XXXXXX	55117M4	X	Gray

Dimensions	Uncoated		Coated Limits			Packaging
	(mm)	(in)	(mm)	(in)		
OD (A)	16.59	0.653	17.27	0.680	max	Bulk Pack 4 bags/box Box Qty= 2000 pcs
ID (B)	10.16	0.400	9.53	0.375	min	
HT (C)	6.35	0.250	7.11	0.280	max	

Electrical Characteristics			Physical Characteristics						
Watt Loss @ 100 kHz, 100mT max(mW/cm <sup>3</sup> )	DC Bias min (oersteds)		Voltage Breakdown wire to wire min (V <sub>AC</sub> )	Break Strength min (kg)	Window Area W <sub>A</sub> (mm <sup>2</sup> )	Cross Section A <sub>e</sub> (mm <sup>2</sup> )	Path Length L <sub>e</sub> (mm)	Volume V <sub>e</sub> (mm <sup>3</sup> )	Weight (g)
	80%	50%							
1050	15.0	28.0	1250	23.0	71.2	19.2	41.2	791	7.0040

Winding Information				Temperature Rating	
Winding Length Per Turn				Wound Coil Dimensions (mm)	
Winding Factor	(mm)	Winding Factor	(mm)	40% Winding Factor	OD 18.8
					HT 10.1
0%	22.0	40%	26.8	Completely Full Window	Max OD 23.7
20%	24.4	45%	27.6		Max HT 15.2
25%	25.0	50%	28.3	Surface Area (mm <sup>2</sup> )	
30%	25.6	60%	29.7	Unwound Core	920
35%	26.2	70%	31.4	40% Winding Factor	1,300
				Curie Temp: 460 °C	
				Coating Temp (Continuous to): 200 °C	
				Notes:	
				M4 stabilization: Controlled stabilization with Inductance stability limits of +/- 0.25% over temperature range -65°C to +125°C measured at low drive level (<10mT). For power inductors use standard stabilization, A2.	

## Typical DC Bias Performance

