

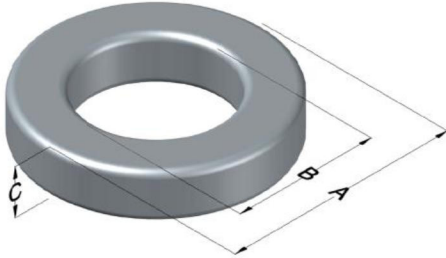

C055016A2

110 Delta Drive
 Pittsburgh, PA 15238
 NAFTA Sales: (1)800-245-3984
 HK Sales : (852)3102-9337
 magnetics@spang.com
 www.mag-inc.com



MPP Permeability (μ)	A_L (nH/T ²)	Core Marking			Coating Color
		Lot Number	Part Number	Inductance Grade	
550	220 \pm 8%	XXXXXX	016	X	Gray

Dimensions	Uncoated		Coated Limits			Packaging
	(mm)	(in)	(mm)	(in)		
OD (A)	6.35	0.250	6.99	0.275	max	Bulk Pack 4 bags/box Box Qty= 10,000 pcs
ID (B)	2.79	0.110	2.29	0.090	min	
HT (C)	2.79	0.110	3.43	0.135	max	

Electrical Characteristics			Physical Characteristics						
Watt Loss @ 100 kHz, 100mT max(mW/cm ³)	DC Bias min (oersteds)		Voltage Breakdown wire to wire min (V _{AC})	Break Strength min (kg)	Window Area W _A (mm ²)	Cross Section A _e (mm ²)	Path Length L _e (mm)	Volume V _e (mm ³)	Weight (g)
	80%	50%							
2000	1.90	4.20	1250	7.3	4.08	4.70	13.6	64.0	0.6136

Winding Information					Temperature Rating		
Winding Length Per Turn				Wound Coil Dimensions (mm)		Curie Temp: 460°C	
Winding Factor	(mm)	Winding Factor	(mm)	40% Winding Factor	OD	7.34	
					HT	4.12	
				Completely Full Window	Max OD	8.81	
					Max HT	5.38	
				Surface Area (mm ²)		Notes:	
				Unwound Core			170
				40% Winding Factor			200
0%	11.6	40%	12.8			Coating Temp (Continuous up to): 200°C	
20%	12.2	45%	12.9				
25%	12.3	50%	13.1				
30%	12.4	60%	13.4				
35%	12.6	70%	13.9				

