

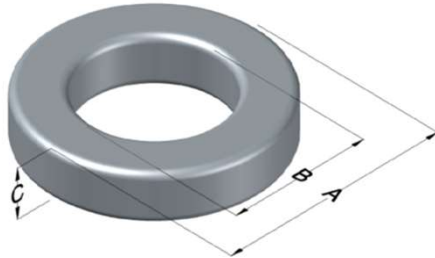

0079091A7X3

110 Delta Drive
 Pittsburgh, PA 15238
 NAFTA Sales: (1)800-245-3984
 HK Sales : (852)3102-9337
 magnetics@spang.com
 www.mag-inc.com



Kool M μ MAX Permeability (μ)	A _L (nH/T ²)	Core Marking			Coating Color
		Lot Number	Part Number	Inductance Grade	
26	111 ± 8%	XXXXXX	79091A7X3	N/A	Black

Dimensions	Uncoated		Coated Limits			Packaging
	(mm)	(in)	(mm)	(in)		
OD (A)	46.74	1.840	47.93	1.887	max	Cardboard cut-outs Box Qty = 45 pcs
ID (B)	28.70	1.130	27.29	1.074	min	
HT (C)	45.72	0.600	47.36	1.865	max	

Electrical Characteristics			Physical Characteristics						
Watt Loss @ 100kHz, 100mT max (mW/cm ³)	DC Bias min (oersteds)		Voltage Breakdown wire to wire min (V _{AC})	Break Strength min (kg)	Window Area W _a (mm ²)	Cross Section A _e (mm ²)	Path Length L _e (mm)	Volume V _e (mm ³)	Weight (g)
	700	80%							
	135	285	3000	99.0	585	396	116.2	138,000	328

Winding Information					Temperature Rating	
Winding Length Per Turn				Wound Coil Dimensions (mm)		Curie Temp: 500°C
Winding Factor	(mm)	Winding Factor	(mm)	40% Winding Factor	OD	53.5
					HT	55.8
0%	115	40%	129	Completely Full Window	Max OD	56.3
20%	122	45%	131		Max HT	67.0
25%	124	50%	133	Surface Area (mm ²)		
30%	125	60%	137	Unwound Core		14,000
35%	128	70%	142	40% Winding Factor		17,000
Notes:						
Coating Temp (Continuous up to): 200°C						

