

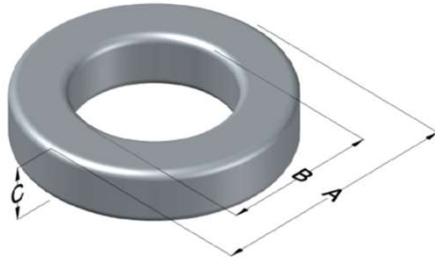

0078192A7X3

110 Delta Drive
 Pittsburgh, PA 15238
 NAFTA Sales: (1)800-245-3984
 HK Sales : (852)3102-9337
 magnetics@spang.com
 www.mag-inc.com



XFlux Permeability (μ)	A_L (nH/T ²)	Core Marking			Coating Color
		Lot Number	Part Number	Inductance Grade	
60	414 \pm 8%	XXXXXX	78192A7X3	N/A	Brown

Dimensions	Uncoated		Coated Limits			Packaging
	(mm)	(in)	(mm)	(in)		
OD (A)	57.15	2.250	58.34	2.297	max	TBD
ID (B)	26.39	1.039	24.98	0.983	min	
HT (C)	45.72	1.800	47.36	1.865	max	

Electrical Characteristics			Physical Characteristics						
Watt Loss @ 50kHz, 100mT max (mW/cm ³)	DC Bias min (oersteds)		Voltage Breakdown wire to wire min (V _{AC})	Break Strength min (kg)	Window Area W _a (mm ²)	Cross Section A _e (mm ²)	Path Length L _e (mm)	Volume V _e (mm ³)	Weight (g)
	80%	50%							
725	80	150	3000	163.0	490	687	125.1	85,900	649

Winding Information					Temperature Rating	
Winding Length Per Turn				Wound Coil Dimensions (mm)		Curie Temp: 700°C
Winding Factor	(mm)	Winding Factor	(mm)	40% Winding Factor	OD	Coating Temp (Continuous up to): 200°C
					HT	
0%	128	40%	141	Completely Full Window	Max OD	Notes:
20%	134	45%	143		Max HT	
25%	136	50%	144	Surface Area (mm ²)		
30%	137	60%	148	Unwound Core	17,000	
35%	139	70%	153	40% Winding Factor	20,000	

