

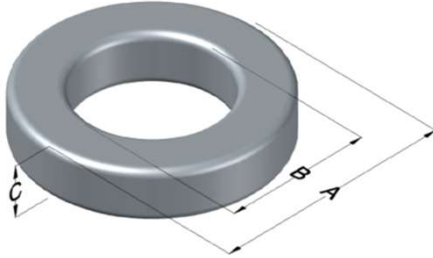

0078191A7X2

110 Delta Drive
 Pittsburgh, PA 15238
 NAFTA Sales: (1)800-245-3984
 HK Sales : (852)3102-9337
 magnetics@spang.com
 www.mag-inc.com



XFlux Permeability (μ)	A_L (nH/T ²)	Core Marking			Coating Color
		Lot Number	Part Number	Inductance Grade	
26	120 \pm 8%	XXXXXX	78191A7X2	N/A	Brown

Dimensions	Uncoated		Coated Limits			Packaging
	(mm)	(in)	(mm)	(in)		
OD (A)	57.15	2.250	58.34	2.297	max	Cardboard cut-outs Box Qty = TBD
ID (B)	26.39	1.039	24.98	0.983	min	
HT (C)	30.48	1.200	31.87	1.255	max	

Electrical Characteristics			Physical Characteristics						
Watt Loss @ 50kHz, 100mT max (mW/cm ³)	DC Bias min (oersteds)		Voltage Breakdown wire to wire min (V _{AC})	Break Strength min (kg)	Window Area W _a (mm ²)	Cross Section A _e (mm ²)	Path Length L _e (mm)	Volume V _e (mm ³)	Weight (g)
	80%	50%							
850	215	380	3000	163.0	490	458	125.1	57,300	415

Winding Information					Temperature Rating	
Winding Length Per Turn				Wound Coil Dimensions (mm)		Curie Temp: 700°C
Winding Factor	(mm)	Winding Factor	(mm)	40% Winding Factor	OD	63.5
					HT	39.7
0%	97.1	40%	110	Completely Full Window	Max OD	63.5
20%	104	45%	112		Max HT	50.1
25%	105	50%	113	Surface Area (mm ²)		
30%	106	60%	117	Unwound Core		13,000
35%	108	70%	122	40% Winding Factor		16,000
Notes:						

