

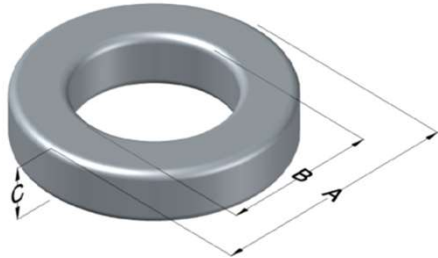

**0078110A7X2**

110 Delta Drive  
 Pittsburgh, PA 15238  
 NAFTA Sales: (1)800-245-3984  
 HK Sales : (852)3102-9337  
 magnetics@spang.com  
 www.mag-inc.com



XFlux Permeability ( $\mu$ )	$A_L$ (nH/T <sup>2</sup> )	Core Marking			Coating Color
		Lot Number	Part Number	Inductance Grade	
60	156 ± 8%	XXXXXX	78110A7X2	N/A	Brown

Dimensions	Uncoated		Coated Limits			Packaging
	(mm)	(in)	(mm)	(in)		
OD (A)	57.15	2.250	58.34	2.297	max	TBD
ID (B)	35.56	1.400	34.15	1.344	min	
HT (C)	27.94	0.550	29.33	1.155	max	

Electrical Characteristics			Physical Characteristics						
Watt Loss @ 50kHz, 100mT max (mW/cm <sup>3</sup> )	DC Bias min (oersteds)		Voltage Breakdown wire to wire min (V <sub>AC</sub> )	Break Strength min (kg)	Window Area W <sub>a</sub> (mm <sup>2</sup> )	Cross Section A <sub>e</sub> (mm <sup>2</sup> )	Path Length L <sub>e</sub> (mm)	Volume V <sub>e</sub> (mm <sup>3</sup> )	Weight (g)
	80%	50%							
725	80	150	3000	107.0	916	296	143.0	42,300	312

Winding Information					Temperature Rating	
Winding Length Per Turn				Wound Coil Dimensions (mm)		Curie Temp: 700°C
Winding Factor	(mm)	Winding Factor	(mm)	40% Winding Factor	OD	65.5
					HT	40.1
0%	82.9	40%	100	Completely Full Window	Max OD	69.1
20%	91.6	45%	103		Max HT	54.5
25%	93.8	50%	105	Surface Area (mm <sup>2</sup> )		
30%	95.5	60%	111	Unwound Core		12,000
35%	98.3	70%	117	40% Winding Factor		17,000
Notes:						

