

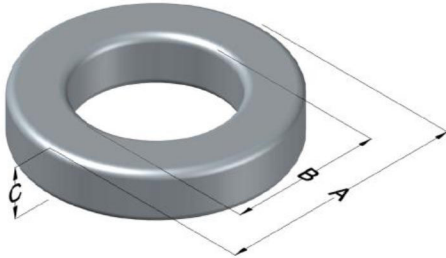

0058272A2

110 Delta Drive
 Pittsburgh, PA 15238
 NAFTA Sales: (1)800-245-3984
 HK Sales : (852)3102-9337
 magnetics@spang.com
 www.mag-inc.com



High Flux Permeability (μ)	A_L (nH/T ²)	Core Marking			Coating Color
		Lot Number	Part Number	Inductance Grade	
26	21 ± 8%	XXXXXX	272	N/A	Khaki

Dimensions	Uncoated		Coated Limits			Packaging
	(mm)	(in)	(mm)	(in)		
OD (A)	6.60	0.260	7.24	0.285	max	Bulk Pack 4 bags/box Box Qty= 10,000 pcs
ID (B)	2.67	0.105	2.16	0.085	min	
HT (C)	4.78	0.188	5.41	0.213	max	

Electrical Characteristics			Physical Characteristics						
Watt Loss @ 100 kHz, 100mT max(mW/cm ³)	DC Bias min (oersteds)		Voltage Breakdown wire to wire min (V _{AC})	Break Strength min (kg)	Window Area W _A (mm ²)	Cross Section A _e (mm ²)	Path Length L _e (mm)	Volume V _e (mm ³)	Weight (g)
	80%	50%							
1250	200	375	1250	11.3	3.63	9.20	13.6	125	0.8600

Winding Information					Temperature Rating	
Winding Length Per Turn				Wound Coil Dimensions (mm)		Curie Temp: 500°C
Winding Factor	(mm)	Winding Factor	(mm)	40% Winding Factor		Coating Temp (Continuous up to): 200°C
				OD	7.41	
				HT	6.11	Notes:
				Max OD	9.17	
				Max HT	7.42	
0%	15.9	40%	17.0	Completely Full Window		
20%	16.4	45%	17.2	Surface Area (mm ²)		
25%	16.6	50%	17.3			
30%	16.7	60%	17.7	Unwound Core	230	
35%	16.9	70%	18.0	40% Winding Factor	260	

