

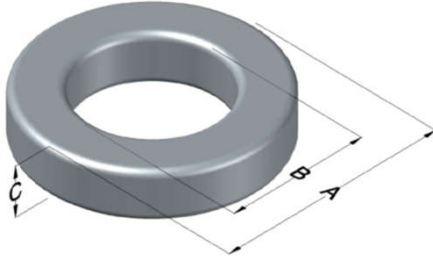

**0055905A2**

110 Delta Drive  
 Pittsburgh, PA 15238  
 NAFTA Sales: (1)800-245-3984  
 HK Sales : (852)3102-9337  
 magnetics@spang.com  
 www.mag-inc.com



MPP Permeability ( $\mu$ )	$A_L$ (nH/T <sup>2</sup> )	Core Marking			Coating Color
		Lot Number	Part Number	Inductance Grade	
147	208 ± 8%	XXXXXX	55905A2	N/A	Grey

Dimensions	Uncoated		Coated Limits			Packaging
	(mm)	(in)	(mm)	(in)		
OD (A)	77.80	3.063	78.94	3.108	max	Cardboard cut-outs Box Qty= 40 pcs
ID (B)	49.23	1.938	48.21	1.898	min	
HT (C)	15.88	0.625	17.02	0.670	max	

Electrical Characteristics			Physical Characteristics						
Watt Loss @ 100kHz, 100mT max (mW/cm <sup>3</sup> )	DC Bias min (oersteds)		Voltage Breakdown wire to wire min (V <sub>AC</sub> )	Break Strength min (kg)	Window Area W <sub>a</sub> (mm <sup>2</sup> )	Cross Section A <sub>e</sub> (mm <sup>2</sup> )	Path Length L <sub>e</sub> (mm)	Volume V <sub>e</sub> (mm <sup>3</sup> )	Weight (g)
	80%	50%							
900	23	43	3000	141.0	1,830	221	196	43,400	355

Winding Information					Temperature Rating	
Winding Length Per Turn				Wound Coil Dimensions (mm)		Curie Temp: 460°C
Winding Factor	(mm)	Winding Factor	(mm)	40% Winding Factor	OD	88.9
					HT	32.0
0%	64.8	40%	89.4	Completely Full Window	Max OD	93.9
20%	77.3	45%	93.2		Max HT	52.0
25%	80.2	50%	96.5	Surface Area (mm <sup>2</sup> )		
30%	82.8	60%	104	Unwound Core	13,000	
35%	86.7	70%	113	40% Winding Factor	23,000	
Notes:						
Coating Temp (Continuous up to): 200°C						

