

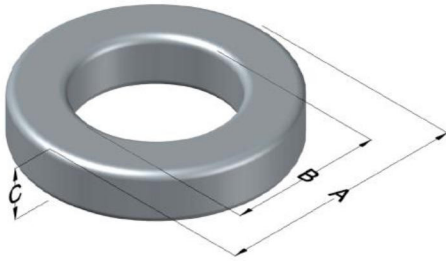

**0055147A2**

110 Delta Drive  
 Pittsburgh, PA 15238  
 NAFTA Sales: (1)800-245-3984  
 HK Sales : (852)3102-9337  
 magnetics@spang.com  
 www.mag-inc.com



MPP Permeability ( $\mu$ )	$A_L$ (nH/T <sup>2</sup> )	Core Marking			Coating Color
		Lot Number	Part Number	Inductance Grade	
200	56 ± 8%	N/A	N/A	N/A	Gray

Dimensions	Uncoated		Coated Limits			Packaging
	(mm)	(in)	(mm)	(in)		
OD (A)	3.94	0.155	4.57	0.180	max	Bulk Pack 5 vials/box Box Qty= 7500 pcs
ID (B)	2.24	0.088	1.73	0.068	min	
HT (C)	2.54	0.100	3.18	0.125	max	

Electrical Characteristics			Physical Characteristics						
Watt Loss @ 100 kHz, 100mT max(mW/cm <sup>3</sup> )	DC Bias min (Oersted)		Voltage Breakdown wire to wire min (V <sub>AC</sub> )	Break Strength min (kg)	Window Area W <sub>A</sub> (mm <sup>2</sup> )	Cross Section A <sub>e</sub> (mm <sup>2</sup> )	Path Length L <sub>e</sub> (mm)	Volume V <sub>e</sub> (mm <sup>3</sup> )	Weight (g)
	80%	50%							
1050	15.0	28.0	-*	2.7	2.32	2.11	9.42	19.9	0.1751

Winding Information					Temperature Rating		
Winding Length Per Turn				Wound Coil Dimensions (mm)		Curie Temp: 460°C	
Winding Factor	(mm)	Winding Factor	(mm)	40% Winding Factor		Coating Temp (Continuous up to): 200°C	
				OD	4.85	Notes:	
				HT	3.73		MPP cores 4.65 mm and smaller are graded into 5% bands. *No voltage breakdown min for A2 or A7 with OD ≤4.65mm
				Completely Full Window		Max OD	
Surface Area (mm <sup>2</sup> )		Max HT	4.75				
		Unwound Core		90			
35%				40% Winding Factor		110	

