

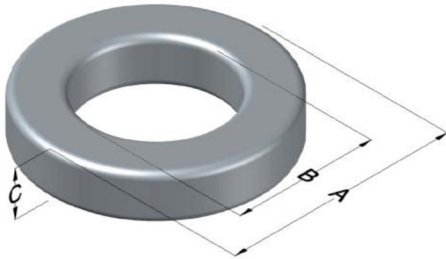

0055043A2

110 Delta Drive
 Pittsburgh, PA 15238
 NAFTA Sales: (1)800-245-3984
 HK Sales : (852)3102-9337
 magnetics@spang.com
 www.mag-inc.com



MPP Permeability (μ)	A_L (nH/T ²)	Core Marking			Coating Color
		Lot Number	Part Number	Inductance Grade	
14	7 \pm 8%	XXXXXX	043A2	N/A	Gray

Dimensions	Uncoated		Coated Limits			Packaging
	(mm)	(in)	(mm)	(in)		
OD (A)	10.16	0.400	10.80	0.425	max	Bulk Pack 4 bags/box Box Qty= 8000 pcs
ID (B)	5.08	0.200	4.57	0.180	min	
HT (C)	3.96	0.156	4.60	0.181	max	

Electrical Characteristics			Physical Characteristics						
Watt Loss @ 100 kHz, 100mT max(mW/cm ³)	DC Bias min (oersteds)		Voltage Breakdown wire to wire min (V _{AC})	Break Strength min (kg)	Window Area W _A (mm ²)	Cross Section A _e (mm ²)	Path Length L _e (mm)	Volume V _e (mm ³)	Weight (g)
	80%	70%							
1600	215	270	1250	12.2	16.4	9.57	23.0	220	1.5200

Winding Information					Temperature Rating				
Winding Length Per Turn				Wound Coil Dimensions (mm)			Curie Temp: 460°C		
Winding Factor	(mm)	Winding Factor	(mm)	40% Winding Factor		OD	11.5	Coating Temp (Continuous up to): 200°C	
				HT	5.96				
				Completely Full Window		Max OD	14.1	Notes:	
						Max HT	8.46		
				Surface Area (mm ²)					
				Unwound Core		370			
				40% Winding Factor		480			
0%	15.4	40%	17.8						
20%	16.6	45%	18.1						
25%	16.9	50%	18.4						
30%	17.1	60%	19.2						
35%	17.5	70%	20.0						

